

## OUR WAY OF LIFE

I write having been out and about on a beautiful sunny afternoon following the refreshing rain of the past few days. Quite apart from all the animal, insect and bird life that is around, the back lanes of our villages are looking lovely in their fresh green leaves and, the garish yellow of the rape being almost over, the beauty of the white flowers blending with the green has come into its own - the hawthorn, horse chestnut, stitchwort, bedstraw, daisies and of course the cow parsley (the 'crowd' my father called it as it 'waved' at us as we passed in the car), holly and elderflower. The red of the poppies just coming into flower and red campion together with the yellow of dandelions, gorse and broom add just a splash of colour. Of course the flowers along the verges will all be mown shortly in the interests of vehicular safety but I do enjoy seeing them while I may.

However all this may change, if we are not careful, if the alterations in the planning laws come about. The ever present threat of being overwhelmed by the out of town development, in the form of huge new extensions to our villages of supermarkets, shopping malls, industrial estates, airport runways and thousands of houses, looks to be coming closer. An out-of-village friend recently mentioned the fact that Gt Bromley had a good little village shop and I was sorry that I had to disillusion her by telling her that it had closed some time ago. The Government is set to close many branches of the post offices across the country in the near future. I hope ours manages to survive so that, although we have lost the shop, we will still have our Post Office. Further, it seems we will be penalised, by being

fined, if we fail to sort our rubbish for recycling properly. My son's bins, in the Midlands, are already gone through by the bin men and rubbish not taken if the 'wrong' rubbish is in the 'wrong' bin. It is all very well to suggest it be separated but it is all thrown together into the back of the bin lorry when collected. Separate bins are needed for different rubbish if it is to be successful and, to avoid an increase in the fly, rat and mouse populations and other nuisances, weekly collections need to continue.

For the most part we are all happy to play our part to help the environment but the threat of penalties can also lead to fly-tipping as well as annoy the rest of us with petty officialdom and bureaucracy and it actually becomes more difficult to play our part if we have to keep going further and further for our daily needs.

### **Great & Little Bromley Village Directory**

The Bromley Messenger is looking to bring out, once maybe twice a year, a separate 'Keep by the Phone' booklet being a Directory of services and information on schools, doctors, hospitals, councillors, recycling etc etc.

Suggestions as to what you would like to see in the Directory would also be welcomed.

Please, to help save me hours looking up on the internet and/or telephone calls, would you send me the following information:

- Mobile Library routes and times through the villages
- Little Bromley up-to-date bus timetables
- Details of local nursery schools.

*Leonie Henderson*

This month's edition of the Bromley Messenger is sponsored by **Great Bromley Parish Council**.

The first monthly meeting of the new parish council, elected on 3<sup>rd</sup> May, took place after the Annual Parish Assembly and the names and appointments of the elected councillors are listed in the parish council news section

of this magazine. It was reassuring to note that almost 60% of those eligible to vote in this ward in the local elections exercised their right to do so.

Two of the major activities in which our parish council was involved last year are now behind us. The public enquiry into the Tendring replacement local plan has now closed and the inspector's findings are likely to be published in early autumn. The village appraisal report was published in March and the new council will be working hard, with your support and assistance, to bring about the changes that you have asked for.

Thanks are due to those people who have volunteered so far to play a role in one or more of the working groups listed in the April edition of the Bromley Messenger. Their help will enable some of the activities to get under way by the end of this month. However, more volunteers are needed for several of the working groups and it is not too late to come forward to offer your help if you are able to do so, in whatever capacity you choose. This is a good opportunity for residents to meet other likeminded individuals in a friendly and constructive forum and produce tangible results which benefit the community.

I look forward very much to working together with parish councillors and residents in the coming months. The parish council is here to represent the people of Great Bromley; if you have any suggestions, concerns or complaints then contact either the parish clerk or any councillor and the council will take appropriate action. Alternatively, please do come along to a parish council meeting where you will be made welcome and have the opportunity to address the council if you so wish.

*Martin Frostick, Chairman, Great Bromley Parish Council*



## OLD COURTHOUSE INN, GREAT BROMLEY

Tel: 01206 250322



The history of the Old Courthouse Inn can be traced back to the seventeenth century when it was originally a Courthouse with the Gallows across the road.

When we bought it thirteen years ago it was in a very bad and derelict condition and if we had not bought it Green King, the owners, were thinking of putting houses on the site and we all know the power of big companies - they normally get what they want.

Over the years we have worked hard and spent a lot of money to get the building as it is today, we hope an attraction to the village especially in the summer when we have all the baskets and flowers in bloom. We have built up a lot of regular trade over the years of people from all over the world and from this country. People come back year after year to stay in our four star Inn. You don't get this business if you have unpleasant staff, no atmosphere or bad food and drink as quoted in the parish appraisal.

The village is lucky to have three pubs all doing their own thing and all raising lots of money for village charities as we have done over the time we have been here.

There are fourteen pubs a week closing in the U.K. and many villages don't even have one pub. If the people in these villages had supported the pubs and village shops when they were open they would still be there now, these people are the first to complain about the loss of village life.

The people in our village that prefer to go to the big combines outside the village to eat and drink should realise that it is these establishments that are closing down village life just like Tesco have closed down the village shops.

We would like to take this opportunity to thank the percentage of the village that support the local pubs.

*Terry and Carole Marshall*

**MATERIAL** for the **JULY 2007** edition of 'The Messenger' should reach the Editor, Leonie Henderson, by **Monday, 18th JUNE, 2007**

please. Contributions from anonymous sources will not be printed. Whilst the editor welcomes contributions, photographs etc this is on the understanding that there is no obligation to publish, that the item may be edited and that there is no breach of copyright. Publication is in good faith and neither the editor nor the publisher accept any liability in respect of the content of any article, photo or advertisement, including any error or omission, responsibility for which remains with the author.

Copy can either be delivered by hand, sent by post or e-mail. (see inside back cover for details) or via the link on the websites [www.greatbromley.org.uk](http://www.greatbromley.org.uk) or [www.littlebromley.org.uk](http://www.littlebromley.org.uk)

***Please support the sponsors of our magazine.***

## FROM THE DOCTORS' SURGERIES

### Ardleigh Surgery

#### Surgery extension

At long last the surgery extension has been completed and was brought into use at the beginning of May. Dr Manders and Dr Bettle have moved into the extension and have their own supplementary waiting area. Dr Manders old consulting room is now available to be used by our Retained GP, Dr Parker and a new GP Registrar who will be starting in August. Janet Burgess, our Health Care Assistant, also



now has her own room which was the former GP Registrar consulting room. The filing cabinets have been moved into a dedicated records room and

we also have a new staff room and a store room. We have also taken the opportunity to redecorate the external walls and re-carpet the existing surgery.

We would like to thank patients for putting up with the noise and disruption, in particular, with the frequent closure of the surgery car park for deliveries. It has all been worthwhile as the end result is a surgery that is far more comfortable for both patients and staff and will reduce the need for room sharing.

#### Practice Nurses

We have appointed a new Practice Nurse, Michelle Black, to replace Catherine Arter who left to take up a post in Ipswich. Michelle will be taking over Catherine's responsibility for the care of patients with asthma.

*Fred Merrin, Practice Manager*

### Great Bentley Surgery

It's an ideal time to stop smoking – if you are one of that dwindling band of addicts who still do. Not only is there now more help available than ever before for anyone who wants to kick the habit, but from July 1<sup>st</sup> it will be illegal to smoke in enclosed public places. You won't be allowed to smoke in your office, or in places like restaurants, clubs or pubs.

Imagine next winter having to stand outside your work-place on cold, wet, windy days just for the pleasure of filling your lungs with tar and a host of other poisonous substances. No more "staff smoking" rooms – they will be illegal. Also, can you really face leaving your friends enjoying the comforts of a decent restaurant while you snatch a quick fag, have a cough then sneak back in damp, half-frozen, hair in a mess and stinking of

smoke? I'm an ex-smoker and I know stopping is difficult, but everyone needs to draw the line somewhere.

I can't help feeling that slapping on nicotine patches for a few weeks and battling through the withdrawal symptoms is a small price to pay for getting rid of a habit that will cost you a fortune and almost certainly kill you early or at the very least, leave you with a crippling chronic disease.

To help you, we now have regular "stop-smoking" clinics here at the surgery. Patches and chewing gum are available on prescription, making them much cheaper than they used to be. All sorts of counselling services and support groups seem to be springing up to help smokers these days, so you would never need to



feel alone or isolated as you take back control of your life and lungs.

Think about it, then ring and book that all-important first session with our smoking cessation adviser. It could be the start of a new you.

On the prescription front, we've had a bit of an odd problem recently with people turning up to collect orders that they believe they have sent by fax, only to find that we haven't actually received them. The cause has generally turned out to be that they have put their request form the wrong way up in their fax machine. All we then receive is a blank sheet, or at best a copy of the wording on the back of the request form. Occasionally, the situation is rescued by a remitting fax number being stamped on the blank sheet, however there is usually no hint as to whom it belongs. Frustration all round!

So, if you want to send prescription requests by fax – and we welcome them on 01206 252496 – please check your user's manual first to avoid disappointment and a wasted trip.

Incidentally, we will shortly be able to receive requests for prescriptions via the internet, but more about that soon, hopefully next month.

I find I now have every sympathy with people who have moaned to me in the past about having to deal with VAT. I always used to think that they were making a terrific fuss about not very much. However, here at the surgery, we have just finished our first year of VAT registration and I HATE IT! It's loads more work for absolutely no benefit. It confuses everyone, because we are what is called "partially exempt", which means that we have to consider every amount of money that we pay out or take in, decide if it is subject to the dreaded VAT or not, and if so, whether we have to account to HM Customs and Revenue for it.

I'm afraid it's had a knock-on effect for

patients as well. We now have to add VAT to all sorts of non-NHS service charges, which makes them more expensive. So, if you notice that some of our charges have jumped, please don't hold it against us – it's all the government's fault.

Finally this month, I've read today that a good long walk in the country is a far better treatment for depression than taking pills. After all that talk of VAT, I'm off to find my walking boots! I wonder if I could get a trip to the Lake District on prescription.

*Hugh Cronin, Practice Manager*



# PARISH COUNCIL NEWS

## GREAT BROMLEY PARISH COUNCIL

[www.essexinfo.net/gbpc](http://www.essexinfo.net/gbpc)

### Report of Great Bromley's Annual Parish Assembly and council meetings held on 10 May 2007

#### New Parish Council

*The newly elected parish council met for the first time and has the following membership:*

Col Martin Frostick OBE	Chairman, Tree Warden, Bromley Messenger management committee
Mrs Sarah Del-Guidice	Recreation ground committee
Mr David Hardy	Recreation ground committee
Mrs Ann Jones	Passenger transport representative
Mr Fred Nicholls	Village Hall management committee representative
Mrs Brenda Perry	
Mr Richard Perry	
Mr Chris Phillips	Vice-chairman, recreation ground committee
Mr Pender Richardson	Accounts monitoring officer

*The council confirmed the following appointments:*

Clerk and Responsible Financial Officer – Ken Bromfield  
Poorlands Charity Trustees – Mr James Wild and Col Frostick  
Footpath Warden – Mr Alan Sievewright  
War Memorial Custodian – Mr G Bloomfield

The recently elected **Tendring District Councillors** are Mrs Rosemary Heaney and Mr Peter Scott. Ms Sarah Candy continues as **Essex County Councillor**.

The parish council has agreed that its councillors can claim both annual allowances of up to £351, plus travel/mileage expenses when attending official meetings outside the parish. Parish councillors can be contacted through the clerk, otherwise their addresses and phone numbers will be posted on the village noticeboards.

#### Annual Parish Assembly

The recently retired chairman, Major Heaney, and other officers presented reports on the council's various activities to the parish assembly. The council's annual report is available from the clerk and will be posted on the parish council's website ([www.essexinfo.net/gbpc](http://www.essexinfo.net/gbpc)).

#### Planning

**The Council considered the following planning applications:**

**Arundel, Ardleigh Road** – canine fitness centre (no objection).

**Harwins, Frating Road** – changes to existing approval (objection).

Tendring District Council has approved the following planning applications:

Bay Trees, Parsons Hill – extension and conservatory.

**Marks Farm, Frating Road** – change of use of ancillary building to business.

The next meeting of the Council will be at 7.30 pm on Thursday 14 June 2007 at the Village Hall Great Bromley.

*Ken Bromfield*

Email: [gbparishcouncil@tiscali.co.uk](mailto:gbparishcouncil@tiscali.co.uk)

## Little Bromley Parish Council

The next meeting of Little Bromley Parish Council will be held on 19th July 2007 at 7.30pm.

For the venue please contact the Parish Clerk on 01206 391015.

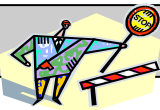

## TEMPORARY ROAD CLOSURES

Under the Road Traffic Regulation Act 1984 - Section 14(2) the following road will temporarily be closed.

**4<sup>th</sup> June 2007 for 5 days** to enable carriageway repairs to be carried out - Green Island, Ardleigh.

An alternative route will be via Bromley Road and Park Road, Ardleigh and vice versa.

**11<sup>th</sup> June 2007 for 5 days** to enable carriageway repairs to be undertaken - Back Lane East, Great Bromley from its junction with Chase Road West for its entire length.

No alternative route is available. Access to Meadow Close will be maintained.

**18<sup>th</sup> June 2007 for 5 days** to enable carriageway repairs to be undertaken. - Morebarn Road, Great Bromley for its

entire length.

An alternative route is via Badley Hall Road, Hall Road and Carringtons Road, ~Great Bromley and vice versa.

**25<sup>th</sup> June 2007 for 5 days** to facilitate carriageway repairs. - Fen Lane, Ardleigh between its junctions with Dead Lane and the B1029.

An alternative route is available via Dead Lane, B1029 AND VICE VERSA. Access to property will be maintained during the closure.

**16 July 2007 for 5 days** - Hilliards Road, Great Bromley for its entire length.

An alternative route is via Stone Road, Mary lane North, Brook Street, Badley Hall Road, Great Bromley and vice versa.

### THE PYLONS

Further to the information in the last two issues of 'The Bromley Messenger' I thank John Appleby for sending me a copy of the plan (pverleaf) of the layout of how the plot of the Pylons used to be.

*Ed.*

## GARDENING TIPS for May

### Chrysanthemums:

Complete stopping of

outdoor-flowering plants

**Shrubs:** Take leaf-bud cuttings of clematis and soft-

wood cuttings of fuchsia, cotoneaster and hydrangea early in the month.

**Dahlias:** Pinch out tips of leading shoots - water and mulch - spray against blackfly

**Irises:** Tall bearded irises may need support during high winds. After flowering cut back stems.

*Frank Griffiths*



## FRIENDS OF LT BROMLEY CHURCH

The Open Morning 28<sup>th</sup> April was a well attended community event. We viewed the events calendar for 2007 and the new permanent display folder which has information and photos about the Friends and past events.

**AIR MINISTRY EXPERIMENTAL STATION 24 (GREAT BROMLEY), 1942**

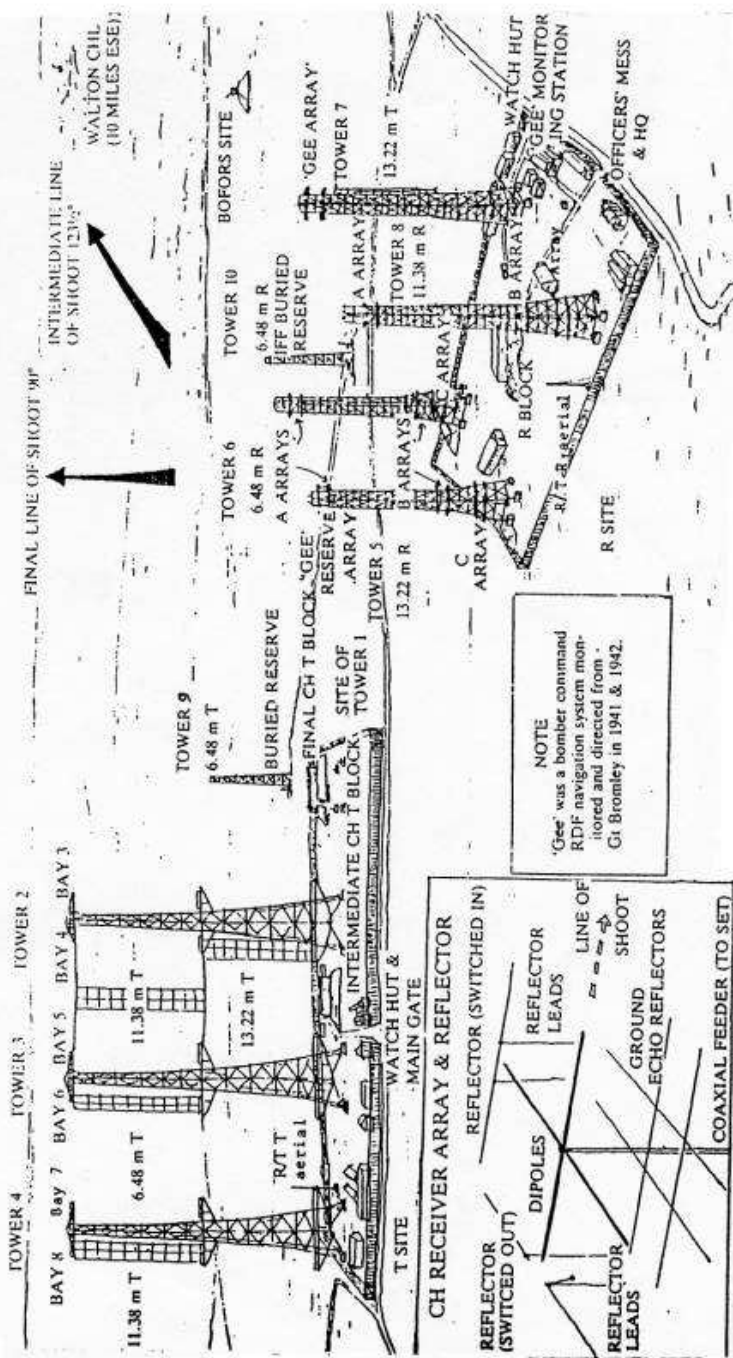



## FROM THE PAST ...

### Little Bromley Sale 1897

C M Stanford and Arthur K Boggis, Auctioneers, jointly held an important Sale of Two Cottages and an Enclosure of Productive Land at Little Bromley on Thursday, 21 January 1897 by order of the Trustees of the late Mr Thomas Brooks. The venue was "The White Hart Hotel, Manningtree".

Lot 19 comprised Two Timber and Thatched Freehold Cottages with good gardens, well of water, and appurtenances, situate in Chequers Road. The occupiers were Smith William

Chaplin whose rent was £3 15s 0d per annum and William Chaplin who paid £3 15s 0d but was a half-yearly tenant.

The productive garden ground adjoining was let to William Chaplin for £3 10s 0d payable each year at Michaelmas. The total rental was £7. Land Tax amounted to 5s 9½d.

Outgoings on the garden were paid by William Chaplin but those on the tenements were discharged by the landlord. William also claimed the piggeries and other outbuildings.

*John Appleby*

## AND 20 YEARS AGO ...

### 1<sup>st</sup> Great Bromley Guides

In March the guides took part in the World's Biggest Kim's Game, sponsored in aid of the Anglia region Girl Guides' new training and activities centre, Hautbois House, in Norfolk, and raised over £28 for this. Some of the Stour Valley trefoil Guild and the District Rangers joined us for a most enjoyable evening.

We entered the Elmstead Division Handicraft Show on 11<sup>th</sup> April and Sophie won a second place certificate, and Tracey a Highly Commended for their pressed flower bookmarks. The following week Sophie, Tracey and Claire gained their Artists Badges ...

In the Spring Bank Holiday week we will be camping at Bentley, Suffolk, with Walton-on-the-Naze Guides.

*[Does anyone know or remember who any of these Guides were? Do they still live in the area? - Ed.]*

## CRICKET CLUB

### 100 CLUB WINNERS FOR MAY

1st.	Mrs. G. Wright
2nd.	Mr. Bryn Jones
3rd.	Mrs. Kay Mitchell



## KITCHEN CORNER

### **DONEGAL STUFFED TROUT**

Serves 4

2 large or 4 small trout  
3 oz ham  
2 oz mushrooms  
2 oz fresh breadcrumbs  
2 teasp chopped parsley  
1 lemon  
3 oz butter  
Cocktail sticks



Chop ham and mushrooms, add crumbs, parsley, salt and pepper and blend with juice of half a lemon and 1 oz of the butter (melted). Wash trout and fill cavities with the stuffing. Fasten with cocktail sticks.

Place in a greased dish, add rest of butter and lemon juice. Bake 375°F/190°C for 45-50 minutes.

You can use filleted trout if you like!

*Jill Frostick*



## WOMEN'S INSTITUTE



For our May meeting, Mr Vic Hainsworth came along to entertain us by showing some of his professional photographs.

Over a period of 21 years, Mr Hainsworth has gathered many pictures, a selection of which he brought to show us. In explaining the reasons why he liked the subject, it may be the shapes, shadows or perhaps light, he was able to give us plenty of good advice and fostered many ideas.

Also in May we consider the Resolutions to be discussed and voted upon at the National Women's Institute Annual General Meeting in June. This year, only one Resolution is being put forward for debate, "Calling for an end to the closure of Community hospitals" as being discussed at the moment. We voted to keep them open.



As usual, our June meeting will be the Members' Meeting which means that the members organise and run the evening, so giving the committee a rest. We do not disclose the content of the evening beforehand which starts at 7.30pm on Wednesday 6<sup>th</sup> June in the Village Hall. We will be pleased to see visitors so why not come along.

*June Willgress*

# *Forthcoming Events*

## **JUNE**

- 2 'Summertime' Concert, St Mary's Church, Ardleigh, 7.30pm
- 2-3 Little Bentley Hall Waterways & Garden Show
- 4 Visit of Trustees of Churches Conservation Trust to Lt Bromley church
- 5 Village Hall committee meeting, Village Hall, 7.30pm
- 6 WI meeting, Village Hall, 7.30pm
- 9 Hamilton Lodge Summer Fete / Plant Sale, 2.00pm
- 14 Gt Bromley parish council meeting, Village Hall, 7.30pm
- 16 W.I. Strawberry Tea, Fryerning, 2.00pm  
'Lt Bromley: the History & Mystery' - talk, Lt Bromley church, 7.00pm
- 17 Festival of Flowers & Music, Lt Bromley church, 12 noon onwards
- 15-17 West Woodhay House Garden Show
- 16/17 Art Exhibition, Elmstead church
- 21 Friendship Club Open Day, Village Hall, 2.00pm
- 21 Essex Wildlife Trusts Charity Quiz, Cross Inn 8:30pm
- 23 Essex Police Band, St George's church, 7.30pm  
Cricket Club Chairman's Day
- 24 London Bridges Walk in aid of Kidney Research UK

## **JULY**

- 7 Coffee Morning, Village Hall, 10.30am
- 8 Colne 25 Bike Ride, starting Colne School
- 9 Sports Day, St George's School
- 15 PTA Summer Fun Day, St George's School
- 19 Lt Bromley parish council meeting, venue ring Clerk, 7.30pm

## **"SUMMERTIME" CONCERT**

The Colchester branch of the National Trust invite you to a concert featuring:

- Songs from the Shows
- Gershwin's 'Rhapsody in Blue'
- A 'Last night at the Proms' finale

St Mary's Church, Ardleigh  
Saturday 2nd June at 7.30pm

Tickets £7.50 (includes a glass of wine or soft drink during interval)  
Please contact David Wright on 01206 231745



## **LONDON BRIDGES WALK**

**24<sup>th</sup> June 2007** in aid of Kidney Research UK

For more information or to take part in the London Bridges Walk please call Kidney Research UK on 08456 121226 or visit [www.kidneyresearchuk.org](http://www.kidneyresearchuk.org)

## GREAT BROMLEY W.I. STRAWBERRY TEA

Saturday 16th June  
2.00pm - 4.00pm

Come and join us in the garden at  
"Fryerning", Hall Road, Great Bromley  
Tel No: 01206 230688  
Tickets/Entry £2.50

Raffle Bric-a-Brac etc.

Proceeds to Great Bromley W.I.  
and A.C.W.W. supporting  
projects in Zambia, Botswana and  
Lesotho



## ESSEX POLICE BAND

23rd June  
at St George's Church at  
7.30pm

Tickets £8 including  
refreshments

To book please telephone  
Barbara Hall on 01206 230673 or  
Marion Bromfield 01206



## THE FRIENDSHIP CLUB OPEN DAY

21<sup>ST</sup> June

Great Bromley Village Hall  
Doors open at 2.00pm

No admission fee

EVERYONE is welcome

You will see many stalls: Cakes, Books,  
Cards, Jewellery, Plants and produce.  
As always a BUMPER RAFFLE - tickets  
available in the Hall.

A representative from the ESSEX AIR  
AMBULANCE will talk to us on the  
emergency services they do.

DO COME ALONG and enjoy a cup of  
tea and a couple of hours to relax and  
meet friends you don't often see.  
We look forward to seeing YOU.



## HAMILTON LODGE TRUST

Parsons Hill, Great Bromley, Colchester

## SUMMER FETE / PLANT SALE

Saturday, 9th June  
2.00pm - 5.00pm

Grand Raffle  
Large variety of Stalls and Entertainment  
Tail Waggers Dog Show  
Free entrance and parking

Registered Charity No. 306080

## FRIENDS OF LT BROMLEY CHURCH



Wednesday 4<sup>th</sup> June  
2.00-2.45 pm

Visit from Trustees of the Churches  
Conservation Trust  
Friends please come to welcome them

Saturday 16<sup>th</sup> June 7.00pm  
Talk by John Appleby

'Little Bromley: the history and mystery'  
(light refreshments provided)

Sunday 17<sup>th</sup> June 12 - 5.00pm  
Festival of Flowers and Music with  
flowers from our gardens and hedgerows

Music at 1.00pm and 4.00pm  
with Ellie O'Grady (soprano)  
Janina Morris (clarinet/saxophone)

and at 3.00pm  
with Gregory Frostick (organ)

Light lunches £1.50 Refreshments 50p.

Free Admission to all events.  
Donations to the Churches Conservation Trust  
Helpers needed for 16<sup>th</sup> or 17<sup>th</sup> June -  
please ring  
Carol Cordwell 01473 395103 or  
Gregory Frostick 01473 424469



The Holbrook Music Society  
*presents*

# Summer Concert

Saturday 16th June  
7.30pm in the Chapel  
The Royal Hospital School

*Five Mystical Songs - Vaughan Williams*  
*Four Coronation Anthems - Handel*

## The Holbrook Choral Society and Orchestra

*Conductor - Peter Crompton Leader - Wendy Brown*

Tickets: £10 available from  
*The Holbrook Music Society Secretary,  
Royal Hospital School, Holbrook IP9 2RX  
enclosing SAE and cheque payable to  
'The Holbrook Music Society'*

Spacious free car parking



# COFFEE MORNING

**7TH JULY**  
Village Hall

10.30am—2.00pm  
To include light lunches

*In aid of Village Hall Funds*

*The Friends of Elmstead Church*

# ART EXHIBITION

Saturday 16th / Sunday 17th June  
in Elmstead Church  
which will be beautifully decorated with  
flowers for the occasion  
Pictures for sale at reasonable prices by  
Essex artists

Saturday 10.30am-5.30pm  
Sunday 12- 5.30pm  
Ploughman's lunches Teas and  
coffees  
Plants, books and home made cakes for  
sale



## BETH CHATTO'S GARDENS

*will be open in aid of the Friends*

Saturday 16th June only

9.00am-5.00pm

Do please come and support these  
events.

*All moneys raised will go to the  
restoration and repair of our Parish  
Church.*

# COLNE 25 BIKE RIDE

**Sunday, 8th July**

This year the Rotary  
Club of Brightlingsea  
& District are holding  
this event for the  
third time.

There are 3 lengths:  
5 miles, 25 miles and  
40 miles.



You can enter either for  
the fun of it or obtain sponsorship for your  
charity or sponsorship for the  
Rotary Charity.

Starting at the Colne School, entrance  
fees apply depending on  
which distance and if a family or not.

Ring John Holding 303135 or go to  
[www.brightlingsea-town.co.uk](http://www.brightlingsea-town.co.uk)  
then Rotary Club for entry forms.



## Great Bromley & Frating Playgroup

At Great Bromley Village Hall.  
Monday & Thursday 9.30-12 noon  
Wednesday 9.15-11.45am  
& 12.15-2.45pm

Session Tel No: 0785 7503103  
(Lunch time session also available)  
Children: 2years-6 months to 5years.  
£5.00 per session. Ofsted inspected.  
For more details/visits, please contact  
Group Secretary-Debbie on 01206  
250183

Thank you to all the children and their parents who took part in the Sponsored Colour Collect. It looks like we should raise enough money to pay for the long awaited and much needed gated outside area! The fencing looks fantastic and will



make life so much easier for everyone at Playgroup, a big thank you to all those involved in organising it!!!

In the last couple of weeks the children have enjoyed face painting, making milk bottle elephants and collage tigers!

Please contact the above number if you are interested in your child starting at Playgroup, we start at 2 years and 6 months until school.

## St. George's (C of E) School, Gt. Bromley

Head teacher: Pat Fitzgerald  
Telephone: 01206 230305

### School in the Community

The Friendship Club visited the School and were entertained with songs from the 40's by the children which was a great success.

The School celebrated St George's Day with a Church service. This was followed by their Annual Sponsored "Fun & Games"

The children return from half Term on June 4th with a visit to the Church to see Saving the World - flower festival.

Cycle training will be given during this term run by helpers of the School as the Police currently do not carry out this function any more.



After School Clubs are: Kwik Cricket, Recorders, Running, Scatterball, Rounders, Activity, Choir, Multisports. Sports Day is on July 9th. Everyone is welcome to attend.

Don't forget to give in your vouchers etc - Tesco, Nestles Box Tops, and ink jet cartridges, Lexmark, HP, Cannon. Just pop them through the letter box.

LBC



## Sallywags

At Great Bromley Village Hall  
Friday Mornings 9.30-11.30am  
0-5years.Parent and child group.  
Activities/themed sessions/play  
equipment etc.  
For more details or visits please  
contact 01206 230625

## THANKS

### STREET COLLECTION

In April a street collection in Springhill Close, in aid of Marie Curie Cancer Care, was carried out and raised £12.30. Many thanks to all who contributed.



# GREAT BROMLEY VILLAGE HALL CHARITY TRUSTEES

The Village Hall committee met on 24<sup>th</sup> April in the hall, the first of the new financial year which began on 1<sup>st</sup> April and runs through to 31<sup>st</sup> March 2008. In an average year the committee meets formally seven times and each meeting lasts about two hours.

The Annual General Meeting of the Village Hall Charity was held on 9<sup>th</sup> May in the Village Hall. 10 of the 11 committee members plus three members of the public were present, apologies being received from a further two people.

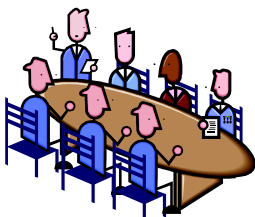

Seven nominations were received for the five elected seats: Dean Dasley, Henry Fairley, Martin Frostick, Pat Petchey and Peter Wenden being elected.

Five were named to fill five of the seven appointed representative positions: Lynda Allam (Cricket Club), Gill Christmas (Badminton club), Beryl Hurst (Friendship club), Frederick Nicholls (Parish Council) and June Willgress (Women's Institute)

with those for the British legion (No Branch using Village Hall) and Pantomime Group (Disbanded) being left in abeyance. One further person was co-opted (up to three possible) Bevan Willgress.

The committee will be lead by Frederick Nicholls as Chairman, with Lynda Allam as Treasurer and Bookings Person, together with Bevan Willgress, Secretary. The Deputy Chairman's position has been left in abeyance for the time being. They next meet on Tuesday, 5<sup>th</sup> June at 7.30pm in the Village Hall.

Many thanks and our appreciation to Brenda and Richard Perry for once again running and organising a Quiz at The Cross Inn on 18<sup>th</sup> May for the Village Hall Funds. We are very grateful for your efforts on our behalf.

The Village Hall committee are organising a coffee morning at the hall on Saturday, 7<sup>th</sup> July from 10.30am until 2.00pm to include light lunches. Please note this date in your diary and come along to see us on the day.

The Christmas Fayre will be held at the Village hall on Saturday 17<sup>th</sup> November and will run from 11.00am until 2.00pm. Any money raised will be shared equally between the Village Hall and St George's Church this year. Please also note this date in your little book.

*Bevan Willgress*

## MOONWALK

**Linda Pinhey, Clare Thompson, Hannah Pinhey and Zoe Bordett** did the Playtex Moonwalk of 26.2 miles through London through the night of 19th May (Moonwalk's 10th anniversary).

15,000 women aim to raise £6m for Breast Cancer Research and Cancer Care. One woman in eight will experience some form of breast cancer in their life.

We decorated our bras and wore tu-tus to stand out! We have trained since January along from Point Clear - St Osyth - Jaywick - Clacton - Holland-on-Sea - Frinton-on-Sea to Walton-on-Naze.



It took us 8½ hours to complete the walk and we hope to have raised £2,000. The atmosphere was brilliant, the event was very well organised with approximately 16,000 walkers aged 13 to 83 taking part setting the streets of London ablaze with sequins and feathers galore! On the first walk, 10 years ago, 65 people took part - how it has grown since then!

*Linda Pinhey*

### Little Bentley Hall Charity Garden Show

*Off A133 north of Colchester*

**Saturday 2nd and Sunday 3rd June**

10.00am—6.00 pm

Entry £6 Children under 16 Free

Gardens open. 100 Trade Stands \* Antiques Road Show & Fine Art Exhibition

Show Gardens & Schools Competitions \* Hot and Cold Food available

This will be the largest Charity Garden event in East Anglia in 2007 when up to 15,000 visitors are expected to flock to these Private Gardens owned by Christopher and Virginia Palmer-Tomkinson. Quite apart from the spectacular gardens, the show will feature 12 Show Gardens, Schools Grub in Tub competitions and 100 trade stands. There is also a Fine Art Show and Antique valuations.

All proceeds will go to local Charities, and we hope to raise more than the £60,000 which was raised when the village last held this event in 2004. Not a bad effort for a small village of just 200 people.





# YOUR NEIGHBOURHOOD ACTION PANEL NEEDS YOUR VIEWS

Are you passionate about the town or village where you live and have strong views on the priorities and problems that need to be tackled urgently?

Are you fed up with environmental crimes – such as dog fouling and litter?

If so, then the Tendring Rural South Neighbourhood Action Panel would like to hear from you.

The panel – which covers St Osyth, Little Clacton, Weeley, Brightlingsea, Alresford, Great Bentley, Thorrington, Elmstead Market, Frating and Great Bromley – meets on a regular basis to discuss a whole range of important issues that affect you.

It will address and resolve community identified priorities – including crime and anti-social behaviour - and report back on the progress being made.

The panel gives residents a real chance to raise awareness about the things that concern them and an opportunity to have their voice heard.

Each panel consists of representatives of the community, voluntary and statutory groups and organisations best placed to make a valuable contribution.

They are led by Essex Police (Eastern Division) in partnership with the Tendring Crime and Disorder Partnership.

The aim is to work up an action plan to deal with the problems identified and one of those has already been successful in stamping out damage to Great Bentley Green caused by vehicles.

Others have tackled nuisance youths in Alresford, and shops close to playing fields selling alcohol to underage teenagers.

The panel is keen to get to grips with environmental issues and is setting up a campaign to clamp down on dog fouling and litter. This will include dishing out Fixed Penalty Notices to offenders.

This is an opportunity for all residents to get involved and help make a real difference to their quality of life and improve it for the better.

## Next Meeting

**The next meeting of the Tendring Rural South Neighbourhood Action Panel will be on Thursday 28<sup>th</sup> June at 7pm at Weeley Council Chambers.**

## DISABILITY ESSEX

is offering FREE Blood pressure Monitoring and Stroke Awareness to your Club/Organisation.

It is an independent charity for disabled people, their carers and dependants.

The Mobile unit

- is run by a qualified registered nurse
- offers a mobile blood pressure and oxygen level checking service
- provides stroke awareness information
- is available to disabled and elderly people throughout Essex, as well as the general public.

This service is completely free to user and venue and has wheelchair access.

Our portable equipment can be brought into the venue is appropriate.

If you are responsible for, or know of anybody who is responsible for, a group of people who would benefit from this service and if you would like to discuss the possibility of a visit from our mobile unit, please contact:

Caroline Carpenter RGN, Project Manager Tel: 07825 179018 Email: [carolinecarpenter@talktalk.net](mailto:carolinecarpenter@talktalk.net) or visit [www.disabilityessex.org](http://www.disabilityessex.org) for more information

## A Dream Invitation

Dates have been announced for Maldon's annual Shakespeare in the Park – the jewel in the crown of Maldon's cultural year. For the first time this year the cast have invited year 7 and 8 students throughout Essex to a special performance ahead of the main run.

Shakespeare in the park began in 2003 to commemorate William Shakespeare's visit to the town of Maldon with his company 'The King's Men' exactly four hundred years earlier and has gone from strength to strength, now pulling in crowds of over 1000 people from all over the Maldon District.

Although the production is professionally produced, all the backstage and onstage work is done by local people, in line with the vision of producing 'Theatre for the Community by the Community'.

Artistic Director Barrie Jaimeson, a veteran of the famous open-air Theatre in Regent's Park, explained why the company feels so passionately about bringing Shakespeare to life for local residents and students, saying: "Shakespeare's understanding of human nature is as relevant today as when he first drew such vibrant characters. Productions in Shakespeare's Globe Theatre drew crowds of

over 2000 people daily who were made up from all sectors of the community. Shakespeare is often thought of as 'snobby, intellectual' theatre but his plays are as relevant as 'Eastenders'. His plays are about life and all its complexities which is of as much interest to the man in the street as to the Queen. Too many of us feel Shakespeare is out of our reach, macTheatre aims to bring it to your doorstep."

Any teacher requiring more information about this year's play can contact Barrie Jaimeson at [bjaimeson@mactheatre.co.uk](mailto:bjaimeson@mactheatre.co.uk)

'A Midsummer Night's Dream' plays the Amphitheatre, Promenade Park, Maldon, Essex from June 21st to June 23rd, with a schools performance on 20th June, and then at Edwin's Hall, Woodham Ferrars, Essex on June 30th and July 1st.

All performances start at 7.30pm.

Tickets for the Promenade Park are available from Maldon Tourist Information, Coach Lane, Maldon. 01621 856503 and are priced at £6.00 and £4.00 concessions. Tickets and information for the performances at Edwin's Hall are available from Sharon Hutton-Mayson on 01245 328480. All profits from the Edwin's Hall performances go to local charities.



### A Midsummer Night's Dream By William Shakespeare

A Midsummer Night's Dream is mac Theatre's Fifth Community 'Shakespeare in the Park' Production

Following last year's successful opening of the Amphitheatre in the Promenade Park with 'The Taming of the Shrew', this year's production will take place at the same venue between the 21<sup>st</sup> June & the 23<sup>rd</sup> June 2007.

A Midsummer Night's Dream is a [romantic comedy](#) written sometime in the late-[1500s](#). It portrays the adventures of four young [Athenian](#) lovers and a group of amateur actors in a moonlit forest, and their interactions with the [fairies](#) who inhabit it and the Duke of Athens. The play is one of Shakespeare's most popular and is widely performed across the world.

**TICKETS NOW ON SALE AT Maldon Tourist Centre, Coach Lane, Maldon. Tel. 01621 856503**

**All performances at 7.30pm, tickets £6/£4 Concessions**

Mac Theatre is The Maldon Actors Company and has been in existence since 1995. As well as the 'Shakespeare in the Park', mac also produces professional productions across Essex and has a Youth Theatre involving young people from across the District performing professionally produced shows – Watch out for 'Dracula – or Fangs 'Aint What They Used To Be'

A production devised by macYouth Theatre coming to a venue near you this October



## THE UNITED PARISHES OF ARDLEIGH AND THE BROMLEYS



Dear Parishioner,

With this magazine you will find a questionnaire form from the Parochial Church of The Bromleys. I would be grateful if you could spend ten minutes or so reading it and filling it in and return it to me or Church. The recent Village Appraisal for Great Bromley highlighted that the majority of respondents felt a strong church was important to village life. The Church Council need now to put some flesh on that and the questionnaire seeks to be part of the process.

Church Of England Churches exist primarily for anyone living in the parish. Certain rights to baptism, marriage and burial follow on from that. Prayers are said daily for parishioners and on Sundays the Eucharist is celebrated as a sign of God's blessing.

In our mobile world it is obvious that parish boundaries often mean little, if anything; just like with supermarkets and schools people make choices and travel to where they wish. It is the same with churches as people have different needs and one place can obviously not cater for

them all. So the Church Council has the task in partnership with myself of seeking to meet those needs.

Some of them are easier to meet than others. Making the place accessible to all and providing adequate lavatory facilities are two that we are working hard on at the moment. Others, particularly spiritual needs, are much more difficult to identify, but we must do so. Restrictions abound like the buildings we have, beautiful but not always the most practical. The priest and people that make up the congregation, beautiful again, but also with their restrictions. We seek to make youngsters feel part of the worshipping community, but this can only be done with trained, certified leaders. I can only lead worship as I believe I'm called to do, anything other would soon fail, or just be boring.

We are greatly blessed here in our villages with our Church life. Your responses will help us to share those blessings more widely. Thank you.

Fr Nicolas.

## ***STOP PRESS***

The Bishop of Southwell and Nottingham has this week offered me the post of Priest in Charge of the Priory Church Our Lady and S Cuthbert, Worksop, with S Giles Carburton and the Chapel of S Mary the Virgin, Clumber Park in Nottinghamshire. After much prayer, thought and discussion I have accepted this post.

My last Sunday in Ardleigh and The Bromleys will be September 2<sup>nd</sup>, which will give me plenty of time to sort myself out with you.

I am to be licensed by the Bishops of Beverley, and Southwell and Nottingham at 3pm on Sunday 7<sup>th</sup> October in the Priory Church.

My new address will be The Vicarage, Cheapside, Worksop, S80 2HX.  
Tel: 01 909 472 180

Please remember in your prayers the Wardens and people here, the people at Worksop, and me.

Thanks. Fr Nicolas

# ST. GEORGE THE MARTYR, GREAT BROMLEY

united with St. Mary the Virgin, Ardleigh



## Services for June

1st	11.00am	The Eucharist	Seven Rivers
2nd	9.00am	The Eucharist & Rosary	St. Mary the Virgin
<b>Sunday 3rd</b>		<b>Trinity Sunday</b>	
	<b>7.30am</b>	<b>Morning Prayer</b>	<b>St. George the Martyr</b>
	<b>8.00am</b>	<b>The Eucharist</b>	<b>St. George the Martyr</b>
	<b>10.30am</b>	<b>The Parish Eucharist</b>	<b>St. Mary the Virgin</b>
	<b>6.30pm</b>	<b>Evening Prayer</b>	<b>St. George the Martyr</b>
4th	9.00am	The Eucharist	St. George the Martyr
6th	6.00pm	The Eucharist	Hamilton Lodge
	7.00pm	The Eucharist	St. Mary the Virgin
7th	9.00am	Little Footsteps	St. Mary the Virgin
	10.00am	The Eucharist	St. Mary the Virgin
	5.00pm	The Magi (Yr 6+)	Old Coal House
8th	11.00am	Holy Communion	Seven Rivers
9th	9.00am	The Eucharist and Rosary	St. Mary the Virgin
<b>Sunday 10th</b>		<b>Corpus Christi Sunday</b>	
	<b>7.30am</b>	<b>Morning Prayer</b>	<b>St. Mary the Virgin</b>
	<b>8.00am</b>	<b>The Eucharist</b>	<b>St. Mary the Virgin</b>
	<b>10.30am</b>	<b>The Parish Eucharist</b>	<b>St. George the Martyr</b>
	<b>6.30pm</b>	<b>Evening Prayer</b>	<b>St. Mary the Virgin</b>
11th		<b>S Barnabas</b>	
	9.00am	The Eucharist	St. George the Martyr
	7.30pm	Patronal Festival	Old Heath
13th	7.00pm	The Eucharist	St. Mary the Virgin
14th	9.00am	Little Footsteps	St. Mary the Virgin
	10.00am	The Eucharist	St. Mary the Virgin
	5.00pm	The Magi (Yr 6+)	Old Coal House
15th		<b>Feast of the Sacred Heart of Jesus</b>	
	11.00am	The Eucharist	Seven Rivers
16th	9.00am	The Eucharist and Rosary	St. Mary the Virgin
<b>Sunday 17th</b>		<b>Trinity 2</b>	
	<b>7.30am</b>	<b>Morning Prayer</b>	<b>St. George the Martyr</b>
	<b>8.00am</b>	<b>The Eucharist</b>	<b>St. George the Martyr</b>
	<b>10.30am</b>	<b>The Parish Eucharist</b>	<b>St. Mary the Virgin</b>
	<b>6.30pm</b>	<b>Evening Prayer</b>	<b>St. George the Martyr</b>
18th	9.00am	The Eucharist	St. George the Martyr
20th	6.30pm	The Eucharist	St. Mary the Virgin
21st	9.00am	Little Footsteps	St. Mary the Virgin
	10.00am	The Eucharist	St. Mary the Virgin
	5.00pm	The Magi (Yr 6+)	Old Coal House
22nd	11.00am	Holy Communion	Seven Rivers
23rd	9.30am	The Rosary	St. Mary the Virgin
<b>Sunday 24th</b>		<b>Birthday of S John the Baptist</b>	
	<b>8.00am</b>	<b>The Eucharist</b>	<b>St. Mary the Virgin</b>
	<b>10.30am</b>	<b>The Parish Eucharist</b>	<b>St. George the Martyr</b>
	<b>6.30pm</b>	<b>Evening Prayer</b>	<b>St. George the Martyr</b>
27th	7.00pm	The Eucharist	St. Mary the Virgin
28th	9.00am	Little Footsteps	St. Mary the Virgin
	10.00am	The Eucharist	St. Mary the Virgin
	5.00pm	The Magi (Yr 6+)	Old Coal House
29th		<b>SS Peter and Paul</b>	
	11.00am	Holy Communion	Seven Rivers
30th	9.30am	The Rosary	St. Mary the Virgin